

- Note: Ensure you do not undermine foundations. If foundations are exposed during the excavation for floor level contact WESTERN BUILDING CONSULTANTS
- Note: All steels covered with two layers of 12.5mm plasterboard to give 30 minutes fire protection.
- Note: Cavity fire stops to be installed to meet part B
- Note: This drawing is to be read in accordance with approved planning and level drawings, care must be taken to ensure that any other expert advice from structural engineer etc is read in conjunction with this drawing.
- Note: Ensure all blockwork returns have an insulated DPC
- Note: Existing drainage system to be used where possible, existing drainage to be assessed prior to starting of works. All foul drainage to connect to existing provision with suitable rodding eye outside of extension. All service and drainage runs to be located where possible prior to excavation of foundations. Due care must be taken during excavation to preserve the integrity of all existing drainage and services. Existing foul and storm drainage to be protected in accordance with Wessex Water requirements, or the local water regulatory body.

Note: Drainage plan to be confirmed

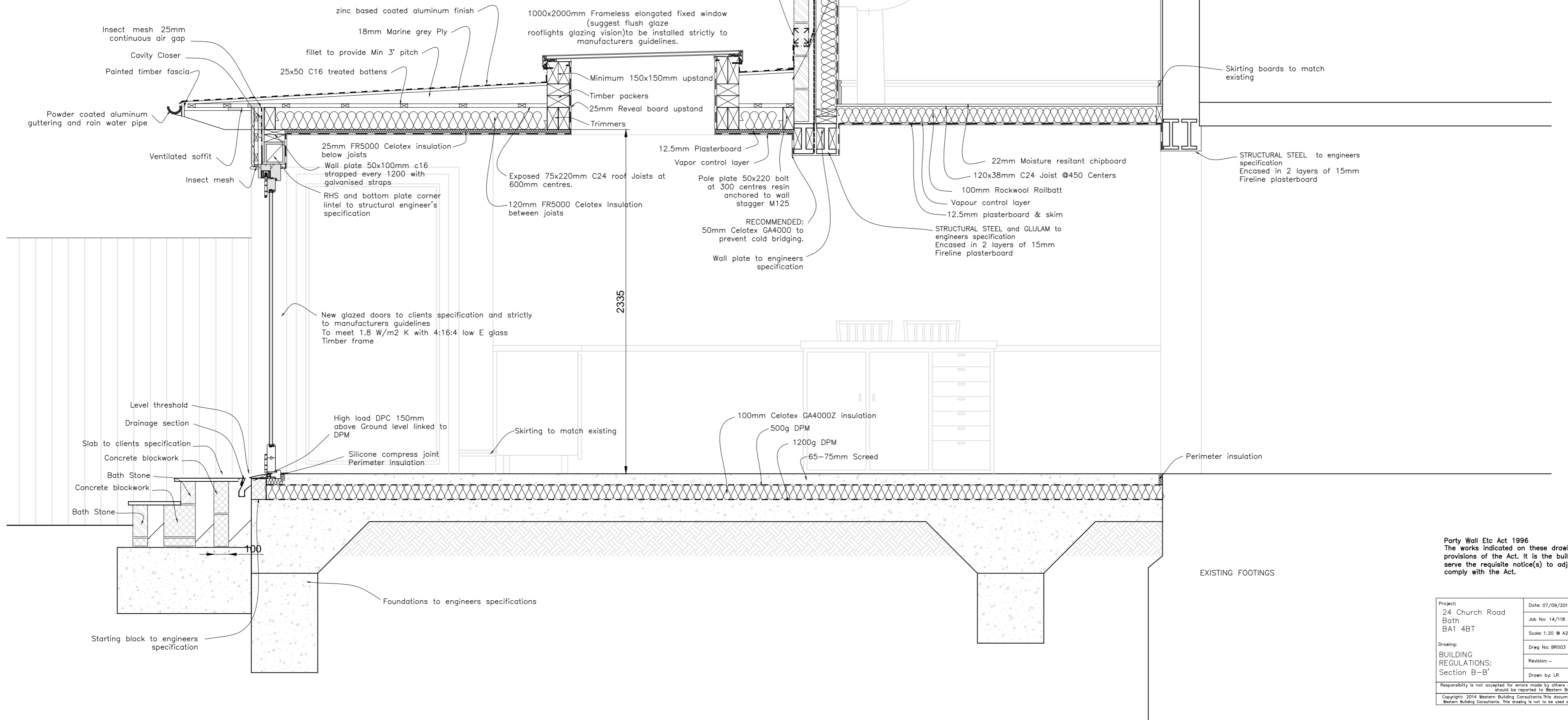

Party Wall Etc Act 1996
The works indicated on these drawings may be within the provisions of the Act. It is the building owner's responsibility to serve the requisite notice(s) to adjoining owners and otherwise comply with the Act.

Project: 24 Church Road Bath BA1 4BT	Date: 07/09/2015 Job No: 14/118 Scale: 1:20 @ A2	
Drawing: BUILDING REGULATIONS: Section B-B'	Drawn by: LR	

Responsibility is not accepted for errors made by others acting from this drawing. All discrepancies should be reported to Western Building Consultants
Copyright: 2014 Western Building Consultants. This document and the design are the copyright of Western Building Consultants. This drawing is not to be used or copied without written authorized consent.